

27 DRYDOCK
AVENUE
BOSTON, MA



NEW 8,921 RSF PLUG & PLAY OFFICE & LIGHT LAB SUBLEASE



AVAILABLE:
Immediately



TERM:
Through
October 2025



RENT:
Negotiable



FF&E:
Office furniture &
lab benching to
be included

2ND FLOOR | 8,921 RSF

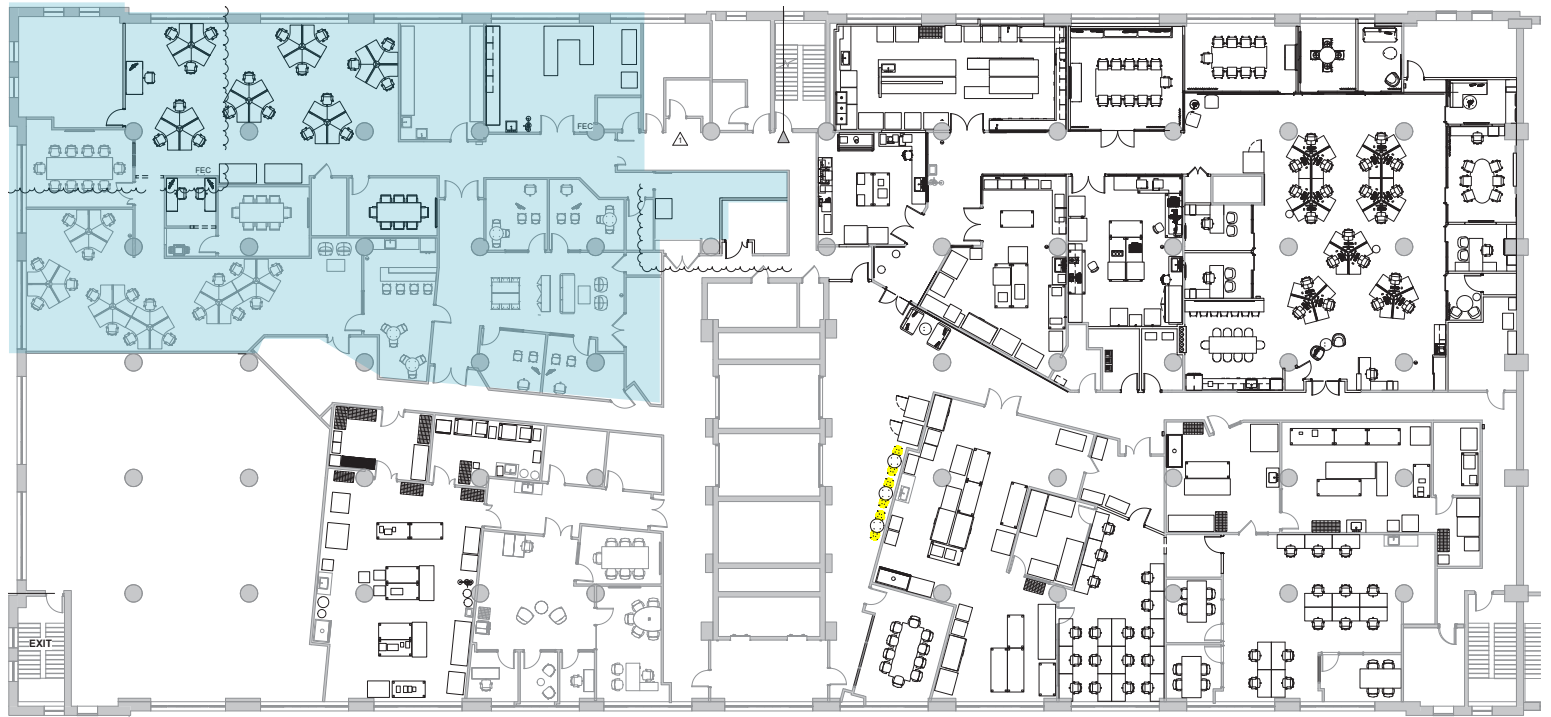

**~\$1M of furniture and decor work done within last 18 months*

